

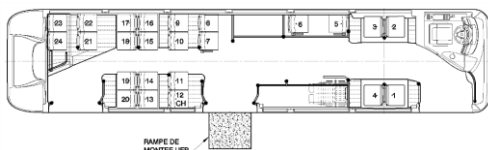

E-WAY FULL ELECTRIC – 12m



24 seats + “wheelchair” space (x) + driver



27 seats + “wheelchair” space (x) + driver

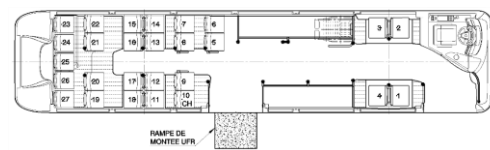

WEIGHTS

Gross kerb weight	according to equipment
G.V.W. max permitted weight	20 000 kg

DIMENSIONS

Overall length	12.060 m
Overhang	2.715 m
Wheelbase	6.120 m
Overall width	2.550 m
Total height, full load	3.350 m
Inside headroom (front part/rear part)	2.384/2.262 m
Slope of the floor (rear part only)	7,2 %
1 st step-height	
Front door	0.320 m
Center & rear door	0.330/0.340 m
Width of front / center / rear doors	1.200 m
Floor height	0.340 m
Ground clearance, under skirt	0.300 m
Front/rear tracking	2.087/1.869 m
Inner Turning radius	9.095 m
Outer Turning radius	10.905 m
Angle of attack / escape	7.4°/7.2°
BRT version in option: LINIUM (Overall length)	12,275 m

E-WAY FULL ELECTRIC – 12m

ELECTRICAL ARCHITECTURE

Synchronous electric motor 120/190 kW (1000 Nm / 2100 Nm)

	NMC (Nickel Manganèse Cobalt) High energy battery	(Lithium- Oxyde Titanate) High power battery
Serial	350 kWh	73 kWh
Option	280, 315, 385 kWh	88 kWh
Charging	Overnight at depot 50 kW	Opportunity fast charging via Off board pantograph 4 poles pantograph – up to 450 kW
Plug	CCS COMBO 2, (max. 100kW)	CCS COMBO 2, (max. 100kW)

CHASSIS AND STRUCTURE - EXTERIOR TRIM

Self-supporting integral structure. Anti-corrosion treatment of chassis by cathoporetic immersion. Body structure consisting in 5 panels (front/rear/left/right/top) made of welded stainless-steel sections and sheet panels. Assembling of the 5 panels to the chassis by bolting. 12mm thick plywood floor, protected by phenolic resins on both sides and wax containing resins on ground side. Composite front and rear ends, roof and side panels. Bonded assembly. Gravel resistant protected wheel arches. Composite front and rear bumpers in 3 parts.

BRT options:

GX LINIUM front end wheel covers.

ACCESS AND DOORS

2 or 3 inward swing/sliding doors. Both leaves of front door are double glazed. Electrical access ramp on the central door. Left and right self-de-frosting rear-view mirrors or motor driven and self-de-frosting rear-view mirrors with integrated flag holders.

GLAZING - HEATING – COOLING

TSA tinted or Shade-Lite panoramic laminated glass windscreen bonded on front face. Bonded side windows. Driver's window: sliding type in front part. TSA tinted glass all round or Grey 40 or Venus 35 tinted except driver's window, front door and rear window.

With or without triangular window on platform
Insulated roof.

2 air exhausters on rear part of the roof

Webasto HVO or fuel (tank 50 l) or electric 20 kW or mix HVO or fuel/electric heater

With or without passenger and/or driver's compartment air conditioning
With or without additional heater in passenger compartment

With or without motor driven or hand actuated opaque or translucent roof hatches

DRIVER'S COMPARTMENT

Adjustable steering wheel (height and angle). Air-suspended driver's seat with adjustment control on right-hand side. VDV instrument panel with warning lamps and control display panel.

Pivoting door, wall behind the driver with a glazed upper part. Interior rear-view mirrors. Left side and front sun visor. Driver's individual with 2 spotlights, luggage box. Average fuel consumption on dashboard.

Adjustable steering wheel and dashboard in height and in slope
With or without anti aggression gate

INTERIOR TRIM

« wheelchair and pram » space

Epoxy or stainless-steel stanchions and handrails.

High wear resistant floor covering up to plinths top. Laminated roof and side panels.

Thermo-formed wheel arches. Polyester ceiling arches.

With or without fire extinguisher

ELECTRICAL EQUIPMENT

2-off 12 V 225 A/h maintenance-free batteries mounted on a sliding support located in an outside compartment at the vehicle front left-hand side.

Converter DC/DC 600/24 V

Passenger compartment lighted by leds lights.

Door step lighting at door opening. Lighting of driver's compartment, paying position and steps. Electricity-saving system for intensive use whilst engine is off.

Thermal circuit-breakers.

Battery re-loading and engine start FENWICK socket

Rear lights with leds : parking lights, stop lights, fog lights, reverse lights and turning lights. Corner marker lights with leds.

FMS socket

4 passenger's loudspeakers and 1 driver loudspeaker and 1 outside loudspeaker

Preparation for front or lateral electronic destination indicator.

With or without flashing/stop indicators on the top of rear end.

With or without atmosphere lightings.

With or without complete radio equipment.

With or without monitoring gong for pedestrian zone.

With or without Front fog lights

With or without 24 V plug in engine compartment

Preparation for ITxPT

With or without Intellibus telematics system

FRONT AXLE

Front independent wheels.

REAR AXLE

ZF AV 133

Axle torque: 9.81 (13x40)

SUSPENSION

Constant height air suspension.

Kneeling and raising system (72 mm stroke) on vehicle right-hand side, controlled from the driving position.

COMPRESSED AIR

Pressure: 10 bars. Electric compressor (output: 400 l/min).

Single tower air dryer. Manual bleeding on the air tanks. Cyclone air cleaner. Oil separator.

BRAKES

Service brakes: air-controlled disc brakes at the front and at the rear. .
ABS-ASR braking system. EBS braking system.

Parking brake and door brake controlled via separate circuits.

Pneumatic parking brake actuated by lack of air, spring chamber on rear wheels.

Service braking: electrical FAE

Brakes applied by opening of the central door.

WHEELS AND TYRES

Michelin or Bridgestone

275/70 R 22.5 tires at the front, twin tires at the rear.

With or without wheel covers.

CERTIFICATION

In accordance with the R100-2 Regulation

In accordance with the appendix 8 of the ECE R107 Regulation and with the appendix 11 of the decree of August 3rd, 2007

IVECO
BUS